

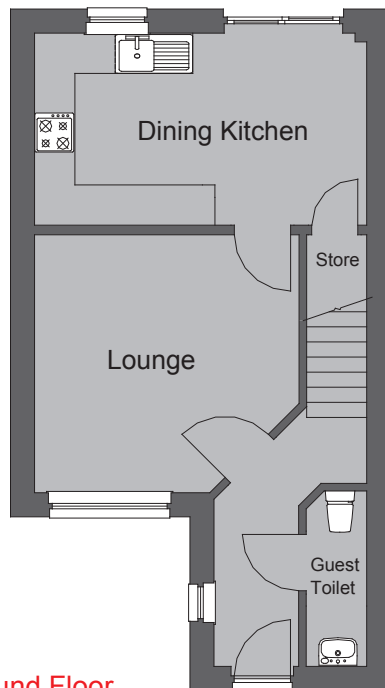

The Belston - 73m²

- Two double bedrooms
- Great cupboard space
- Guest toilet downstairs
- Large family kitchen



Ground Floor



First Floor

Lounge: 3.84 x 3.94 metres
 Dining Kitchen: 2.86 x 4.95 metres
 Guest Toilet: 2.61 x 0.09 metres

Bedroom 1: 2.94 x 3.41 metres
 Bedroom 2: 3.21 x 2.31 metres
 Bathroom: 1.92 x 2.52 metres